

4 3 2 1

REVISIONS		DATE		APPROVAL	
ZONE	UTR.	DESCRIPTION			

D C B A

NOTES UNLESS OTHERWISE SPECIFIED:

1. NOMENCLATURE: AUTOMATIC ONE-WAY RELIEF VALVE (EITHER PRESSURE OR VACUUM BUT NOT BOTH).
2. PERFORMANCE: SEE TABLES ON SHEET 2.
3. MATERIALS:
 - 3.1 HOUSING, STEM (NOT SHOWN), AND NUT: ALUMINUM ALLOY.
 - 3.2 SPRING (NOT SHOWN), RETAINING RING AND SCREEN: STAINLESS STEEL
 - 3.3 ENVIRONMENTAL O-RING AND O-RING SEAL (NOT SHOWN): BUNA-N.
 - 3.4 WASHER: ACETAL.
4. FINISH: ALUMINUM ALLOYS BLACK ANODIZED IAW MIL-A-8625, TYPE II, CLASS 2.
5. THE FOLLOWING ITEMS FURNISHED AS PART OF THIS ASSEMBLY MAY BE PURCHASED SEPARATELY:
 - P/N 296008 ENVIRONMENTAL O-RING
 - 296011 WASHER
 - 296010-5 NUT
6. RECOMMENDED INSTALLATION TORQUE: 20-25 LBS-IN.

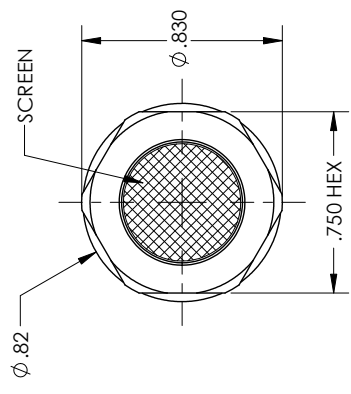
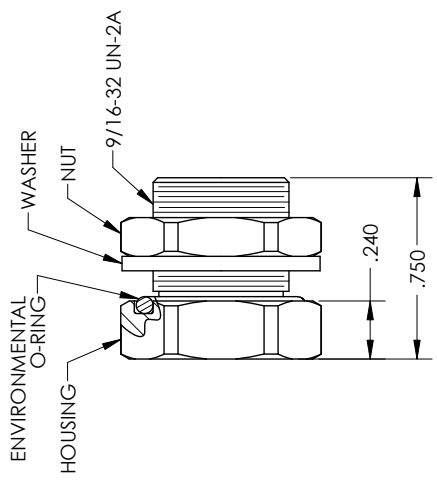

CONTAINER NO.		DATE		DRAWN		CHECK		DATE		TITLE	
		11-8-16		M. ONTIVEROS		APPROVED		By Patrick M. Lane at 3:33 pm, Nov 08, 2016		VALVE, ONE-WAY RELIEF	
INTERPRET DIMENSIONS AND TOLERANCES IAW ANSI Y14.5M-1994 UNLESS OTHERWISE SPECIFIED DIMENSIONS ARE IN INCHES		FINISH		MATERIAL		MFG. WT.		S&L WT.		REV.	
DECIMALS .XX ± .015		4.								B 08992	
ANGLES ± .3°		USED ON		NEXT ASSY.		NEXT ASSY.		NEXT ASSY.		SCALE 2/1	
TOLERANCES: .XX ± .010		APPLICATION		PER ASSY.		PER ASSY.		PER ASSY.		RELEASE DATE	
DO NOT SCALE DRAWING										SHEET 1 OF 2	
PART NO.		QTY. RECD.		FINAL		NEXT ASSY.		USED ON		REV.	
										-	

AGM CONTAINER CONTROLS, INC.
P.O. BOX 40020 - TUCSON, ARIZONA 85717-0020

4 3 2 1

ZONE		LITR.		REVISIONS	
DESCRIPTION		DATE		APPROVAL	

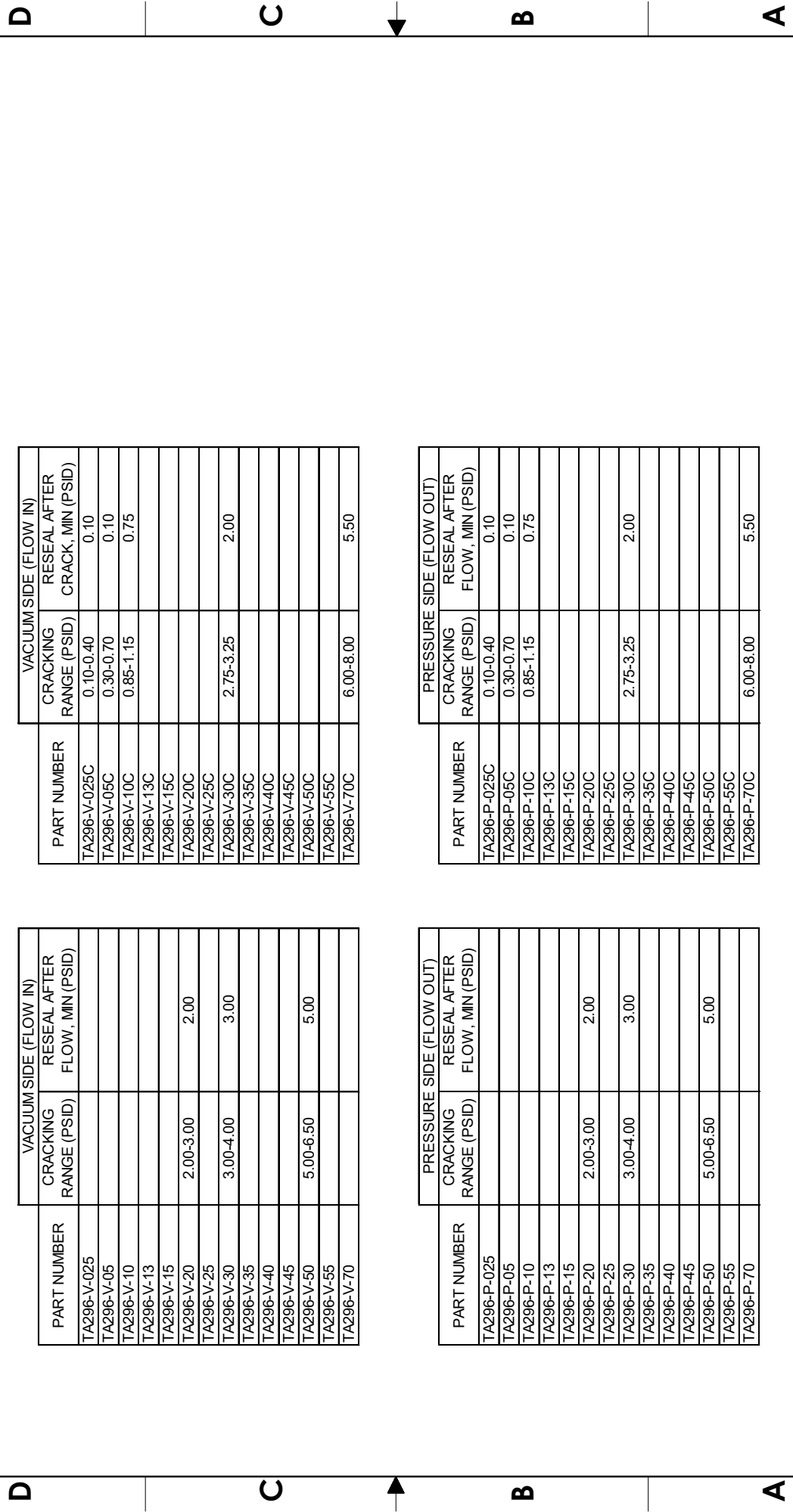

VACUUM SIDE (FLOW IN)	
PART NUMBER	RESEAL AFTER FLOW, MIN (PSID)
TA296-V-025	
TA296-V-05	
TA296-V-10	
TA296-V-13	
TA296-V-15	
TA296-V-20	2.00
TA296-V-25	
TA296-V-30	3.00
TA296-V-35	
TA296-V-40	
TA296-V-45	
TA296-V-50	5.00
TA296-V-55	
TA296-V-70	

VACUUM SIDE (FLOW IN)		
PART NUMBER	CRACKING RANGE (PSID)	RESEAL AFTER CRACK, MIN (PSID)
TA296-V-025C	0.10-0.40	0.10
TA296-V-05C	0.30-0.70	0.10
TA296-V-10C	0.85-1.15	0.75
TA296-V-13C		
TA296-V-15C		
TA296-V-20C		
TA296-V-25C		
TA296-V-30C	2.75-3.25	2.00
TA296-V-35C		
TA296-V-40C		
TA296-V-45C		
TA296-V-50C		
TA296-V-55C		
TA296-V-70C	6.00-8.00	5.50

PRESSURE SIDE (FLOW OUT)	
PART NUMBER	RESEAL AFTER FLOW, MIN (PSID)
TA296-P-025	
TA296-P-05	
TA296-P-10	
TA296-P-13	
TA296-P-15	
TA296-P-20	2.00
TA296-P-25	
TA296-P-30	3.00
TA296-P-35	
TA296-P-40	
TA296-P-45	
TA296-P-50	5.00
TA296-P-55	
TA296-P-70	

PRESSURE SIDE (FLOW OUT)		
PART NUMBER	CRACKING RANGE (PSID)	RESEAL AFTER FLOW, MIN (PSID)
TA296-P-025C	0.10-0.40	0.10
TA296-P-05C	0.30-0.70	0.10
TA296-P-10C	0.85-1.15	0.75
TA296-P-13C		
TA296-P-15C		
TA296-P-20C		
TA296-P-25C		
TA296-P-30C	2.75-3.25	2.00
TA296-P-35C		
TA296-P-40C		
TA296-P-45C		
TA296-P-50C		
TA296-P-55C		
TA296-P-70C	6.00-8.00	5.50

PART NUMBERS SHOWN ABOVE WITHOUT PERFORMANCE ARE NOT CONFIGURED BUT WILL BE AVAILABLE UPON REQUEST

SIE	FSCM NO.	DWG. NO.	REV.
B	08992	TA296	-
SCALE		2/1	SHEET 2

4 3 2 1